

# Product Data Sheet

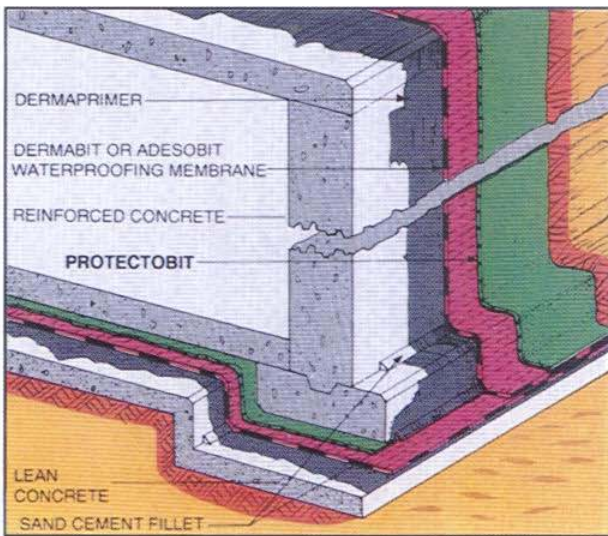

PUBLICAION NO.: 502/E/R-1/FEB '04

## A PROTECTION MEMBRANE



**PROTECTO BIT** is available in roll form, one metre wide x ten metres long or other lengths upon request. **PROTECTO BIT** is flexible and can be 'formed' around curved or rounded surfaces. **PROTECTO BIT**, whilst not designed as a waterproofing material, is impervious to water, giving additional overall security to any waterproofing system.

### USES

Typical uses for **PROTECTO BIT** include foundation walls and between slab construction such as : parking garage decks, planter boxes, pools, kitchens, bathrooms, plaza decks, roof terraces, tunnels and promenade decks, etc.

### GENERAL

**PROTECTO BIT** has been specially developed to provide a strong protective barrier for delicate waterproofing systems, thus preventing penetration by sharp aggregate during backfilling operations and damage from light construction traffic.

### DESCRIPTION

**PROTECTO BIT** Protection Membrane is a flexible material constructed on a strong 250 gm/m<sup>2</sup> non-woven polyester base which has been impregnated and coated with a mixture of bitumen modified with plastomers, and additives. These combined properties make **PROTECTO BIT** resistant to mechanical shock and chemical reaction.

The lower and upper surface are covered with a high density polyethylene film.

### APPLICATION

**PROTECTO BIT** Protection membrane is installed to provide a continuous protective layer over the waterproofing membrane. On horizontal surfaces, the material is simply unrolled and butt jointed. Trim around any projections with a sharp knife. On vertical surfaces, the material should be temporarily held in place or fixed with **DERMAPLAST** using the Spot Bonded Method. If necessary, joints may be covered with a suitable tape.

Alternatively, **PROTECTO BIT** may be welded in position by heating its lower surface with a propane torch during unrolling, taking care to avoid damage to the waterproofing material with the naked flame. **PROTECTO BIT** may also be mechanically fixed to the concrete by fasteners. **Protectobit** should be terminated 6-8 inches above the waterproofing membrane line.

## TECHNICAL DATA

DERMABIT PRODUCTS ARE TESTED AT RANDOM INTERVALS BY INDEPENDENT LABORATORIES TO INTERNATIONAL STANDARDS AND THE RESULTS OF THESE TESTS ARE AVAILABLE ON REQUEST. IN ADDITION, EACH BATCH MANUFACTURED IS SUBJECT TO STRICT QUALITY CONTROL PROCEDURES TO ENSURE IT MEETS APPROPRIATE AND APPLICABLE STANDARDS AND/OR NORMS.

### Physical Properties of Protecto-bit

Property	Typical Result				Test Method
Reinforcement	250 grms/M2 non-woven polyester mat				
Tensile Strength					UEAtc
Longitudinal	910 N/5cm				
Transversal	850 N/5cm				
Elongation					UEAtc
Longitudinal	46%				
Transversal	52%				
Tear Strength					UEAtc
Longitudinal	230 N				
Transversal	330 N				
Puncture Resistance					UNI 8202 Part 11 UNI 8202 Part 12
Static	PS5 (30 Kg) 24 hrs				
Dynamic	PD4 (5 N.M.)				
Water Absorption	less than 0.2%				
Thickness	3 mm	4 mm	5 mm	6 mm	
Weight/M2	3.4 Kg	4.5 Kg	5.6 Kg	6.7 Kg	
Roll Size	1 x 10 m	1 x 10 m	1 x 10 m	1 x 8 m	

## TYPICAL APPLICATIONS

MECHANICAL

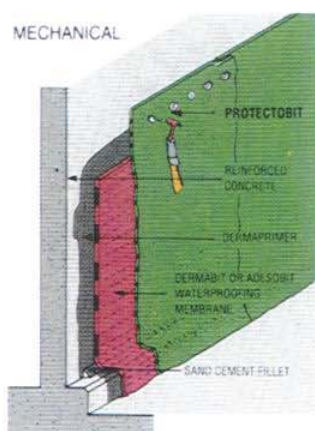

ADHESIVE

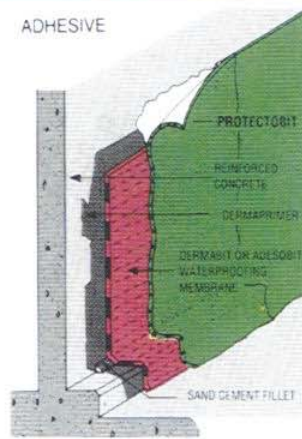

#ORCH-ON



## VERTICAL

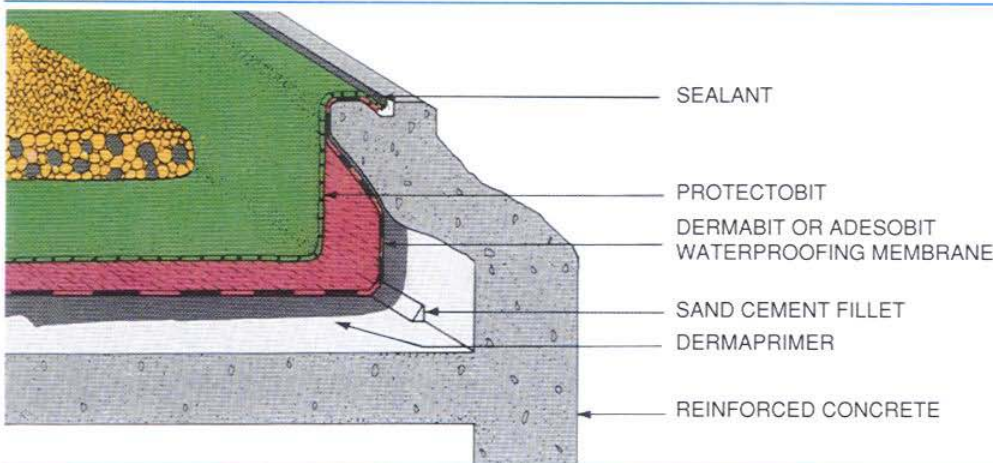

## HORIZONTAL

The above data are average figures obtained from the tests of various samples and are subject to the tolerances defined in the specified test methods.

### DWI, DERMABIT WATERPROOFING INDUSTRIES COMPANY LTD.

**Head Office** : P. O. Box 10308 - Jubail 31961 Saudi Arabia  
Tel.: (03) 3410464 Telefax : (03) 3410481  
Telex : 832162 DWI SJ

**Riyadh Branch** : P. O. Box 5945 - Riyadh 11432 Saudi Arabia  
Tel.: (01) 4645988, 4657761 - Fax: (01) 4634100

**Jeddah Branch** : P. O. Box 3589 - Jeddah 21481 Saudi Arabia  
Tel.: (02) 6976374, 6973309 - Fax : (02) 6976374

**Khobar Branch** : P. O. Box 153 - Al-Khobar 31952 Saudi Arabia  
Tel.: 8985506 - Direct : 8640270, 8640283 - Ext. 282, 283  
Fax : (03) 8985506

**Internet** : <http://www.dermabit.com>

**E-Mail** : [http://www.gjerm@dermabit.com](mailto:http://www.gjerm@dermabit.com)

Submitted by :